

## ○ DETAIL SPEC

TEMPERATURE  
RANGE

0°C~50°C / 0°C~90°C

ELECTRICAL  
RATING

220V/16A

SWITCH CIRCUIT

Single Pole Double Throw (SPDT)

THERMOSTAT  
WEIGHT

120g

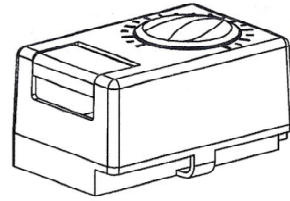
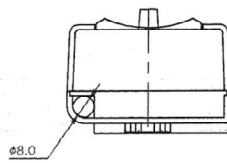
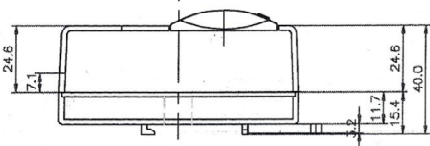
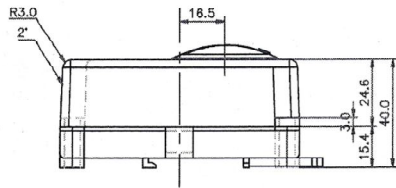
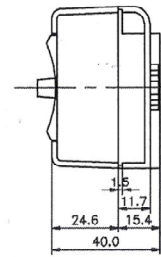
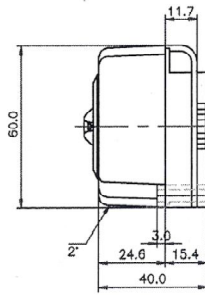
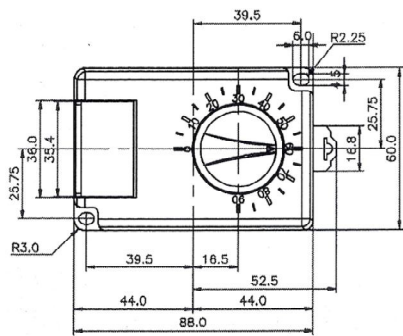

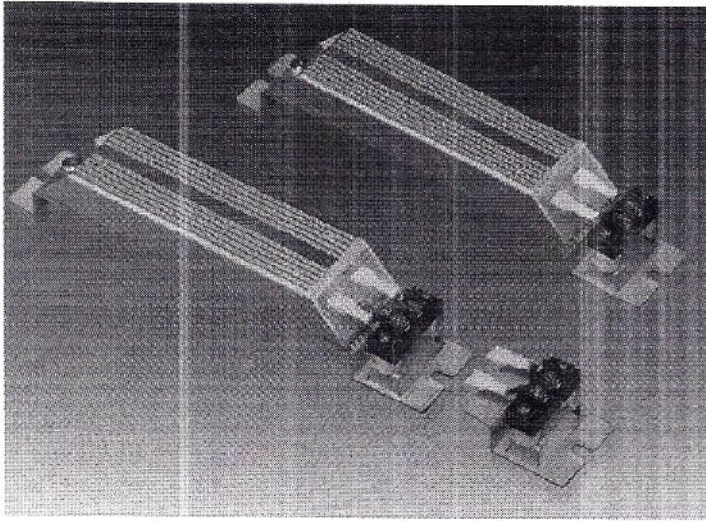

■ STANDARD SPECIFICATION

ITEM NO.	SPEC	REMARK
CYSH-AL	60W, 80W, 100W, 150W, 200W, 300W	TERMINAL BLOCK
CYSH-AL1	60W, 80W, 100W, 150W, 200W, 300W	TERMINAL
CYSH-AL2	60W, 80W, 100W, 150W, 200W, 300W	LEAD WIRE

\*AC220V/110V 150W

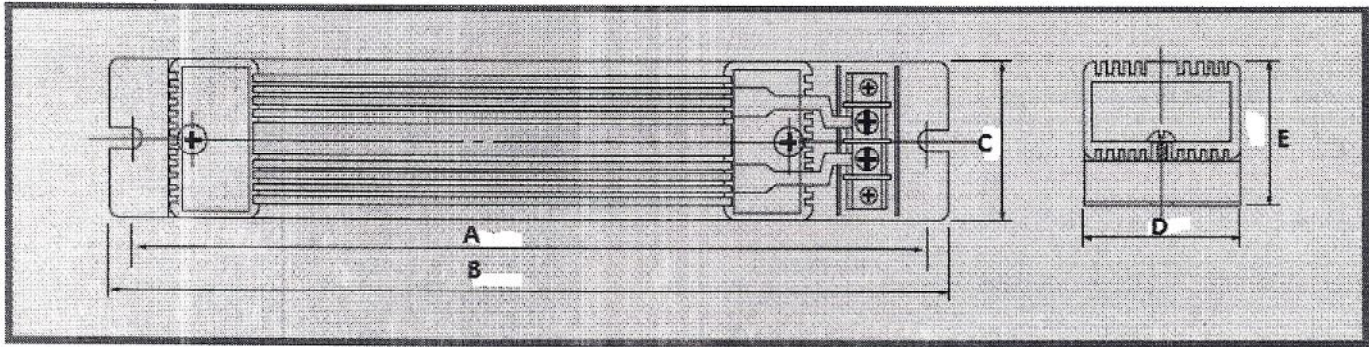

ITEM NO.	SPEC	A	B	C	D	E
CYSH-AL	60W	140	150	40	40	37
	80W	190	200	40	40	37
	120W	250	260	40	40	37
	150W	250	260	40	40	37